

THIS DRAWING IS THE SOLE PROPERTY OF PARLEG INC. AND IS SUBJECT TO BEING RETURNED UPON REQUEST. IT SHALL NOT BE REPRODUCED IN WHOLE OR PART WITHOUT WRITTEN PERMISSION OF PARLEG INC. ANY VIOLATION IS PROHIBITED UNDER SEVERE PENALTIES.

REVISION RECORD			
LET	DESCRIPTION	BY	DATE
A	RELEASED	TT	2025
B	ECR #8048	BAM	5/25
C	ECR #8141	BAM	7/25
D	ECR #8162	MW	8/25
E	ECR #8279	ON	5/25

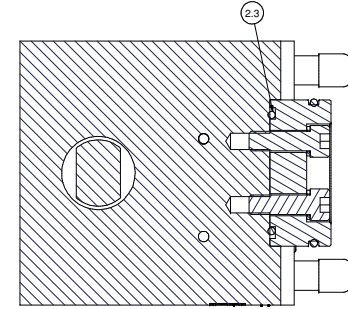

SECTION B-B

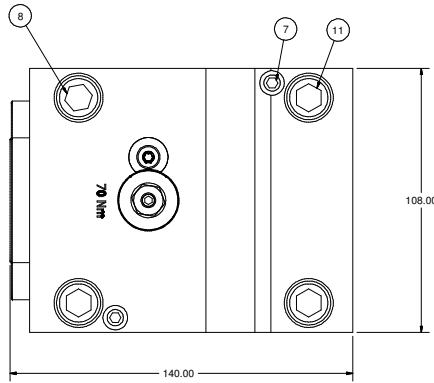
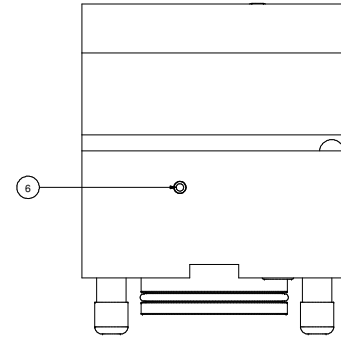
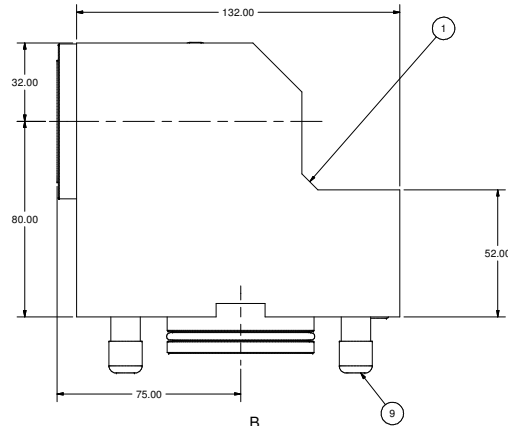
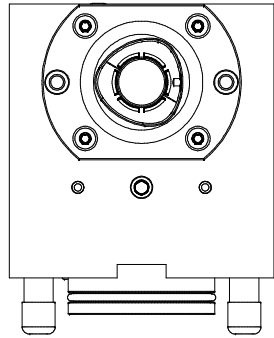
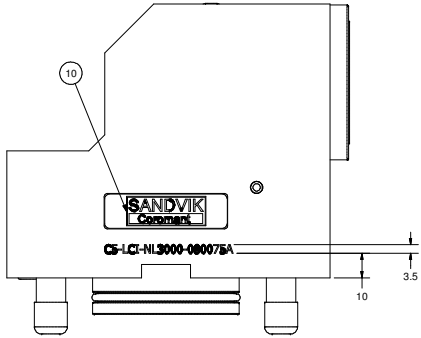

NOTE ORIENTATION OF CLAMPING UNIT

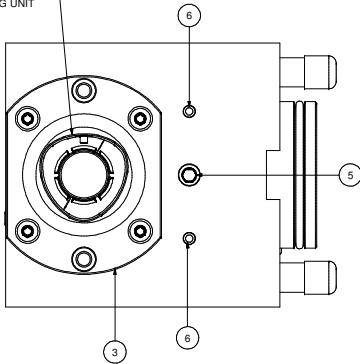

CLEAN WITH LOCTITE 7070
APPLY LOCTITE 262 PER
MANUFACTURER SPECIFICATION
(FIRST 3 THREADS MIN.)
TORQUE TO 39 Nm (2X)

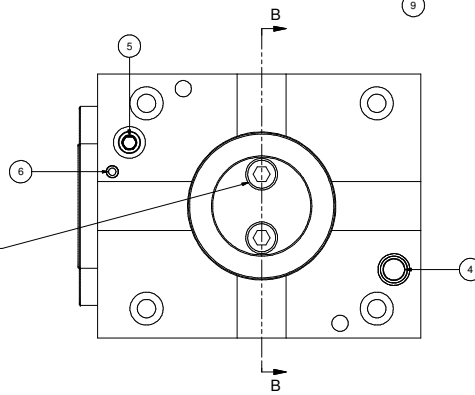

Parts List			
ITEM	QTY	PART NUMBER	DESCRIPTION
1	1	C5-080075A-1	BODY, BORING BAR HOLDER - CAPTO C5
2.3	1	202-788-4470	O-RING 44.5 x 3
2.5	2	SHCSM8X25	CAP SCREW, M8 x 25
2.6	1	202-731-4470	O-RING 54.5 x 3
2.7	2	014-112	M8 LOCK WASHER
3	1	C5-CU-CS-11	CAPTO C5 CLAMPING UNIT, STATIC
4	1	204-009-4470	O-RING, 9 x 2
5	2	SSPLG0125BSPT	1/8" BSPT PIPE PLUG
6	5	MB 600-050	KOENIG EXPANDER SEALING PLUG
7	2	SSM8X30	SET SCREW, FLAT POINT, M8 x 30
8	2	SHCSM12X120	CAP SCREW, M12 x 120
9	4	FCWA-0111-019	M12 THREAD CAP
10	1	LB-SANDVIK	SANDVIK LABEL
11	2	SHCSM12X60	CAP SCREW, M12 x 60

PARLEG	WORLD HEADQUARTERS 200 PERSHON PARKWAY FAIRPORT, NEW YORK 14455	PARLEG INC.	11/20204
DATE	SCALE	BY	CHKD
11/20204	NONE	T. TANDO	
DESIGNED BY	DATE	CHECKED BY	REV
			E

WEIGHT: 7.9KG

PART NUMBER C5-LCI-NL3000-080075A