

**DAEWOO TOOLING**



# History

Parlec is established in Rochester N.Y., as a job shop specializing in the manufacturing of Sulky Hubs.

1948

Parlec begins producing and distributing the Numertap and Autofacer product lines.

1973

Parlec expands its product line with the introduction of Toolholders, which are sold as Numertap and Autofacer accessories.

1977

The first Parsetter TMM is produced.

1980

Parlec builds a new 42,000 square-foot, state-of-the-art manufacturing facility just outside of Rochester in Fairport, N.Y.

1985

Parlec begins to manufacture and distribute its own line of Boring Tools.

1992

Parlec becomes ISO 9001 certified. Parlec's sales triple from 1992-1997.

1997

Parlec further enhances its product line to include Workholding. Construction of a 58,000 square-foot plant addition begins.

1998

Parlec enters the Asian market with the opening of a sales and service office in Nanjing China.

2003

Parlec acquires Bristol Tool. Driven and static tools are added to Parlec's extensive product line. A new sales, engineering and distribution facility opens in Bristol, England.

2004

Parlec continues to expand its world wide footprint by opening a Wholly Owned Foreign Enterprise in Nanjing. This gives the company full sales, engineering, customer support and distribution capabilities on 3 continents.

2006

# Parlec

## **WORLDWIDE LEADER IN TOOLING, WORKHOLDING, AND PRESETTING SOLUTIONS**

For more than fifty years, Parlec has been producing world-class products and solutions for our valued customers as well as fulfilling the needs of our employees who have made our success possible. In this mission, we continue to succeed as our sustained growth has demonstrated. Parlec is your total machining solution, and here's why:

### **PRODUCTS**

Six major product lines including solutions for toolholding, boring, tapping, presetting, workholding, and driven and static tooling. Over 8,000 individual products.

### **SUPPORT**

Worldwide engineering, service, manufacturing, and development support. Over 500 locations throughout the world offering sales, distribution, and product support.

#### **NORTH AMERICA**

101 Perinton Parkway  
Fairport, NY 14450

#### **UNITED STATES**

Tel: 585 425-4400  
Fax: 585 425-7542  
Tel: 800 866-5872  
Fax: 800 866-5917

#### **EUROPE**

Unit 'E' Syston Centre  
Station Rd., Kingswood  
Bristol, BS15 4GQ

#### **UNITED KINGDOM**

Tel: +44 (0) 117 967 4881  
Fax: +44 (0) 117 960 3800

#### **ASIA**

No. 360 Hushan Road  
Science Park  
Jiangning District  
Nanjing, China 211100

#### **CHINA**

Tel: 86-25-6661-2228  
Fax: 86-25-6661-2228

### **MANUFACTURING**

Over 120,000 square feet of manufacturing capabilities. Manufacturing expertise in North America, United Kingdom/Europe, and Asia to ensure the best service levels possible to our customers throughout the world.

### **QUALITY**

ISO 9001: 2000 Certified

*“That's what makes Parlec  
MEASURABLY BETTER”*

### PUMA 230, 240, 1500, 2000, 2500, TT 1500, 1800

#### DRIVEN TOOLS

Part Number	Description	Output Spindle	Ratio	Speed Max	Coolant Type	Drawing Index #
311.15938.000	X-AXIS STR-SHORT SWITCH T/CLNT ER25 6000R	ER25	1:1	6000	Internal & External	1
311.15939.000	X-AXIS STR LONG SWITCH T/LNT ER25 6000R	ER25	1:1	6000	Internal & External	2
311.15941.000	Z-AXIS SETBACK 90D SWITCH T/C ER25-6000R	ER25	1:1	6000	Internal & External	3
311.15942.000	Z-AXIS 90 DEG SWITCH T/CLNT ER25 6000RPM	ER25	1:1	6000	Internal & External	4

NOTE: 311.15939.000 will not fit in Puma 230 or 240.

### MX2000, 2500 & TT2000, 2500

#### DRIVEN TOOLS

Part Number	Description	Output Spindle	Ratio	Speed Max	Coolant Type	Drawing Index #
313.10010.000	STRAIGHT EXT COOL - ER32 4000RPM	ER32	1:1	4000	External	5
313.10020.000	STRAIGHT THRU COOL - ER32 4000RPM	ER32	1:1	4000	Internal & External	6
313.20010.000	90-DEG EXT COOL - ER32 4000RPM	ER32	1:1	4000	External	7
313.20020.000	90-DEG THRU COOL - ER32 4000RPM	ER32	1:1	4000	Internal & External	8
313.60010.000	STR ARBOR TOOL EXT COOL-22MM 4000RPM	ER32	1:1	4000	External	9
313.60020.000	90-DEG ARBOR TOOL EXT COOL-22MM 4000RPM	ER32	1:1	4000	External	10

# Daewoo Tooling

## DRAWING INDEX

**INDEX NUMBER: 1**  
311.15938.000

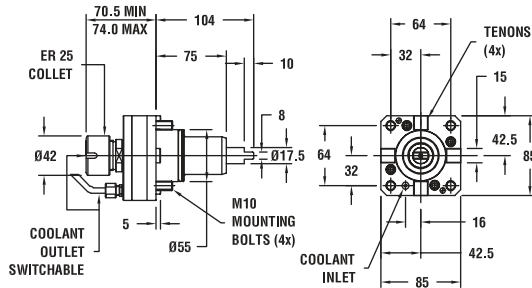

**INDEX NUMBER: 2**  
311.15939.000

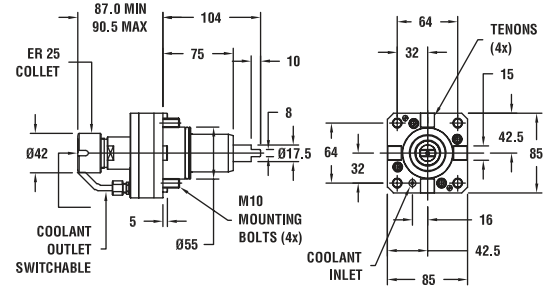

**INDEX NUMBER: 3**  
311.15941.000

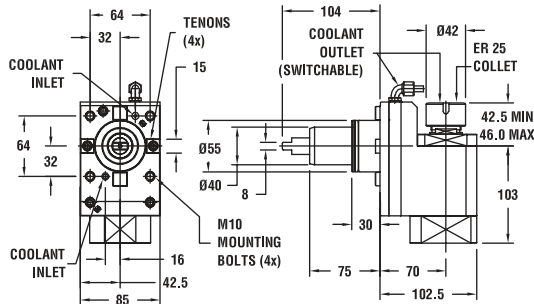

**INDEX NUMBER: 4**  
311.15942.000

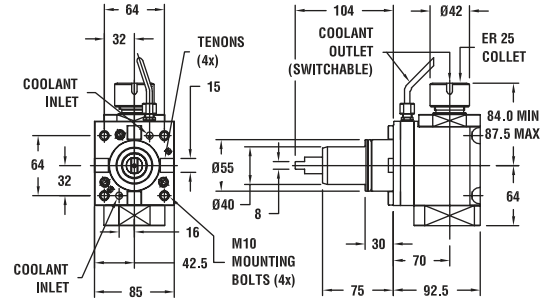

**INDEX NUMBER: 5**  
313.10010.000

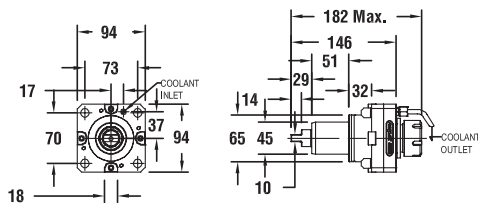

**INDEX NUMBER: 6**  
313.10020.000

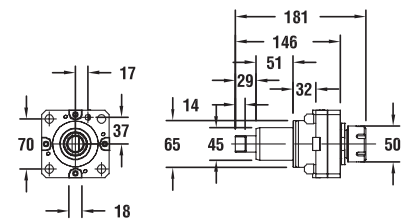

**DRAWING INDEX (CONTINUED)**

**INDEX NUMBER: 7**  
313.20010.000

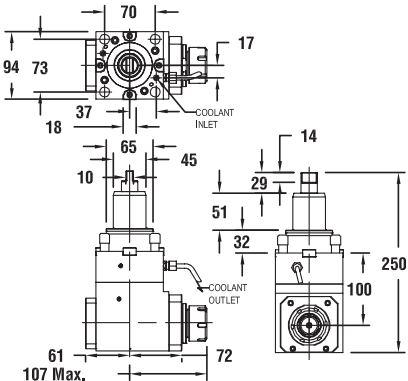

**INDEX NUMBER: 8**  
313.20020.000

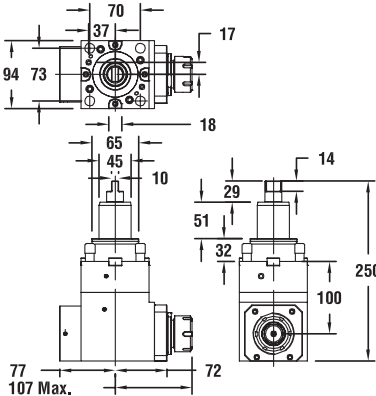

**INDEX NUMBER: 9**  
313.60010.000

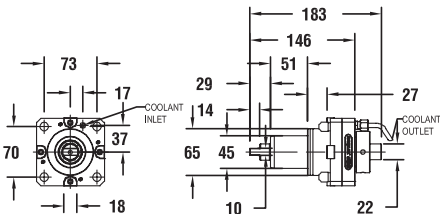

**INDEX NUMBER: 10**  
313.60020.000

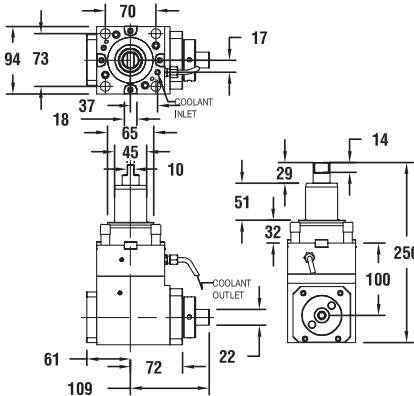

DAEWOO TOOLING

# Notes

---

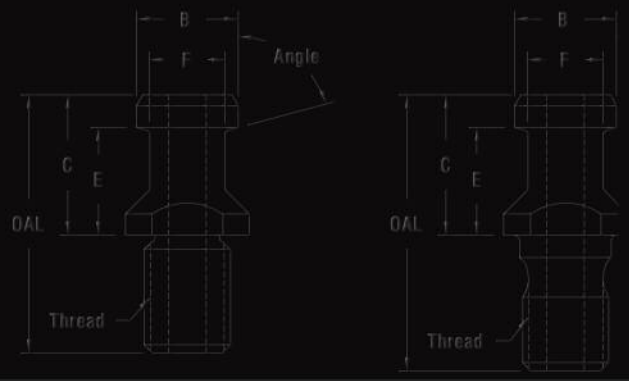
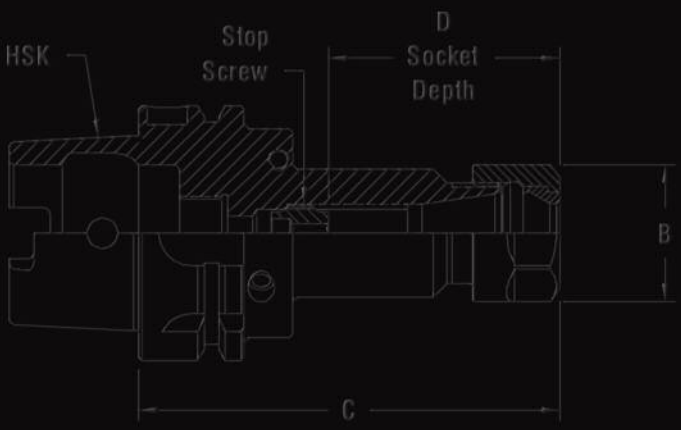

TOOLHOLDING • TAPPING • BORING • WORKHOLDING • DRIVEN & STATIC • PRESETTING



VISIT US ONLINE

[www.parlec.com](http://www.parlec.com)

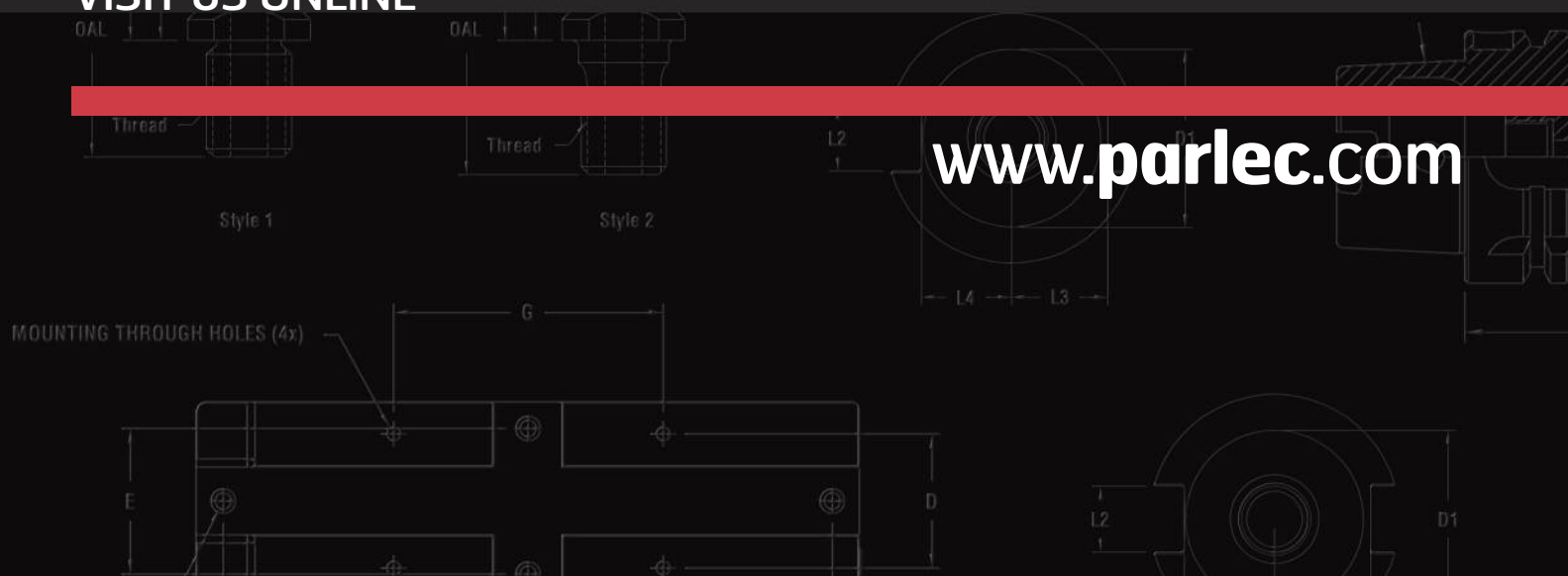



Your **total** machining solution.

**PARLEC WORLD HEADQUARTERS**

101 Perinton Parkway  
Fairport, NY 14450

**UNITED STATES**

Tel: 585 425-4400  
Fax: 585 425-7542  
Tel: 800 866-5872  
Fax: 800 866-5917

**PARLEC EUROPE**

Unit 'E' Syston Centre  
Station Rd., Kingswood  
Bristol, BS15 4GQ

**UNITED KINGDOM**

Tel: +44 (0) 117 967 4881  
Fax: +44 (0) 117 960 3800

**PARLEC ASIA**

No. 360 Hushan Road  
Science Park  
Jiangning District  
Nanjing, China 211100

**CHINA**

Tel: 86-25-6661-2228  
Fax: 86-25-6661-2278

