

# Modular Shanks

## V-Flange Shanks

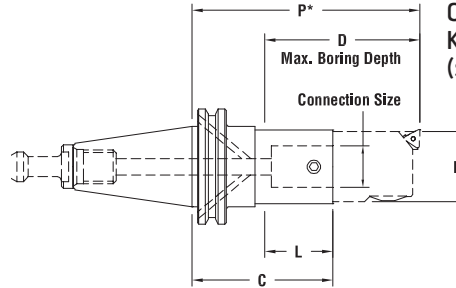

50 Taper  
C50-PC6-6  
shown here.



Order Retention Knob separately (see pages 98-101).

### 40 TAPER

Part Number	Connection Size	Flange Coolant***	B	C	D	L	P*	Weight (lbs.)
C40-PC2-2	PC2	-	.944	2.07	2.00	.56	3.54	2.4
C40-PC2-3	PC2	-	.944	3.33	3.15	1.95	4.80	2.5
C40-PC2-4	PC2	-	.944	4.11	3.94	2.74	5.59	2.6
C40-PC3-3	PC3	-	1.22	3.15	3.20	1.78	4.76	2.6
C40-PC3-5	PC3	-	1.22	5.12	5.57	3.74	6.73	3.3
C40-PC4-1	PC4	-	1.75	1.38	1.75	-	3.23	2.2
C40-PC4-3	PC4	C40B-PC4-3	1.54	2.87	3.15	1.50	4.72	2.7
C40-PC4-6	PC4	-	1.54	6.02	6.30	4.26	7.87	4.3
C40-PC5-3	PC5	-	1.97	2.48	3.15	1.11	4.72	2.8
C40-PC5-6	PC5	-	1.97	5.63	6.30	4.26	7.87	5.5
C40-PC6-3**	PC6	C40B-PC6-3	2.52	2.00	3.42	.63	4.80	3.1
C40-PC6-4	PC6	C40B-PC6-4	2.52	2.72	3.94	1.34	5.51	3.3
C40-PC6-6	PC6	-	2.52	5.08	6.30	3.70	7.87	6.3

### 50 TAPER

Part Number	Connection Size	Flange Coolant***	B	C	D	L	P*	Weight (lbs.)
C50-PC2-2	PC2	-	.94	2.07	2.00	.56	3.54	7.0
C50-PC2-4	PC2	-	.94	4.11	3.94	2.74	5.59	7.0
C50-PC2-5	PC2	-	.94	5.29	5.12	3.92	6.77	7.3
C50-PC3-4	PC3	-	1.22	3.94	4.39	2.56	5.55	7.7
C50-PC3-5	PC3	-	1.22	5.12	5.57	3.74	6.73	7.7
C50-PC3-6	PC3	-	1.22	6.30	6.13	4.30	7.91	8.1
C50-PC4-4	PC4	C50B-PC4-4	1.54	3.61	3.94	2.24	5.46	7.6
C50-PC4-6	PC4	-	1.54	6.02	6.30	4.65	7.87	8.7
C50-PC4-8	PC4	-	1.54	7.60	7.88	6.22	9.45	9.5
C50-PC5-4	PC5	-	1.97	3.27	3.94	1.89	5.51	7.8
C50-PC5-6	PC5	-	1.97	5.63	6.30	4.26	7.87	9.7
C50-PC5-8	PC5	-	1.97	7.20	7.88	5.83	9.45	10.9
C50-PC5-10	PC5	-	1.97	9.57	10.24	8.19	11.81	12.8
C50-PC6-4	PC6	C50B-PC6-4	2.52	2.72	3.94	1.34	5.51	7.7
C50-PC6-6	PC6	-	2.52	5.08	6.30	3.70	7.87	10.8
C50-PC6-8	PC6	-	2.52	6.65	7.88	5.28	9.45	12.8
C50-PC6-10	PC6	-	2.52	9.02	10.24	7.64	11.81	15.9
C50-PC6-12	PC6	-	2.52	11.38	12.60	10.00	14.17	19.1
C50-PC7-6	PC7	-	3.54	3.27	6.30	1.89	7.87	10.0
C50-PC7-8	PC7	-	3.54	5.27	8.30	3.89	9.87	15.3
C50-PC7-10	PC7	-	3.54	7.20	10.24	5.83	11.81	20.3

### 60 TAPER

Part Number	Connection Size	B	C	D	L	P*	Weight (lbs.)
C60-PC6-4	PC6	2.52	3.10	4.20	1.60	5.90	22.6
C60-PC6-12	PC6	2.52	11.10	12.20	9.60	13.90	34.0
C60-PC7-10	PC7	3.54	7.30	10.22	5.80	11.91	35.2

Part numbers in **bold face** are in-stock items.

\*Compute "P" dimensions by adding "C" dimensions of all components used. Maximum bore depth "D" may be increased by using extension adapters. \*\* Deviates from ANSI B5.50 1994 - No clearance for some tool changers.\*\*\*Other sizes available on request.

# Modular Shanks

## DIN-69871 Shanks, Form ADB

### BORING

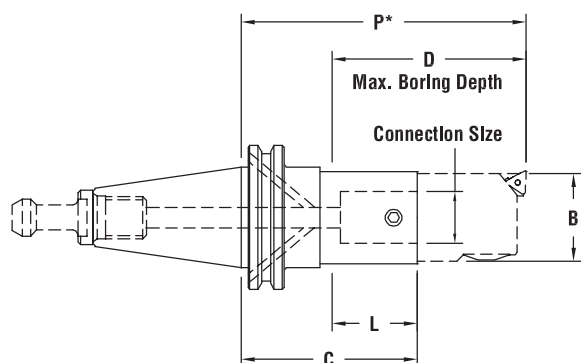

Form B Coolant can be closed with screw for through spindle coolant applications.

#### DIN 40 TAPER

Part Number	Connection Size	B	C	D	L	P*	Weight (lbs.)
<b>D40-PC2-80</b>	PC2	.94	3.34	3.15	1.93	4.72	2.4
<b>D40-PC3-80</b>	PC3	1.22	3.15	3.19	1.77	4.72	2.6
<b>D40-PC4-50</b>	PC4	1.54	1.38	1.85	-	3.23	2.2
<b>D40-PC4-80</b>	PC4	1.54	2.87	3.15	1.50	4.72	2.8
<b>D40-PC4-160</b>	PC4	1.54	6.02	6.30	4.25	7.87	4.4
<b>D40-PC5-80</b>	PC5	1.97	2.48	3.15	1.10	4.72	2.8
<b>D40-PC6-80</b>	PC6	2.52	2.00	3.43	0.63	4.80	3.0
<b>D40-PC6-100</b>	PC6	2.52	2.72	3.94	1.34	5.51	3.3
<b>D40-PC6-160</b>	PC6	2.52	5.08	6.30	3.70	7.87	6.4

#### DIN 50 TAPER

Part Number	Connection Size	B	C	D	L	P*	Weight (lbs.)
<b>D50-PC2-100</b>	PC2	.94	4.09	3.94	2.76	5.51	7.0
<b>D50-PC2-130</b>	PC2	.94	5.27	5.12	3.90	6.69	7.2
<b>D50-PC3-110</b>	PC3	1.22	3.94	4.37	2.56	5.51	7.7
<b>D50-PC3-160</b>	PC3	1.22	6.30	5.91	4.29	7.87	8.1
<b>D50-PC4-100</b>	PC4	1.54	3.58	3.94	2.20	5.51	7.7
<b>D50-PC4-160</b>	PC4	1.54	6.02	6.30	4.65	7.87	8.8
<b>D50-PC4-200</b>	PC4	1.54	7.60	7.87	6.22	9.45	9.5
<b>D50-PC5-100</b>	PC5	1.97	3.27	3.94	1.89	5.51	7.7
<b>D50-PC5-160</b>	PC5	1.97	5.63	6.30	4.25	7.87	9.7
<b>D50-PC6-100</b>	PC6	2.52	2.71	3.94	1.34	5.51	7.7
<b>D50-PC6-160</b>	PC6	2.52	5.08	6.30	3.70	7.87	10.8
<b>D50-PC6-200</b>	PC6	2.52	6.65	7.87	5.28	9.45	12.8
<b>D50-PC6-260</b>	PC6	2.52	9.01	10.24	7.64	11.81	15.8
<b>D50-PC6-320</b>	PC6	2.52	11.37	12.60	10.00	14.17	19.2

Part numbers in **bold face** are in-stock items.

\*Compute "P" dimensions by adding "C" dimensions of all components used. Maximum bore depth "D" may be increased by using extension adapters.

\*\*\*Other sizes available on request.

# Modular Shanks

## BT Shanks



40 Taper  
B40-PC6-4  
shown here.

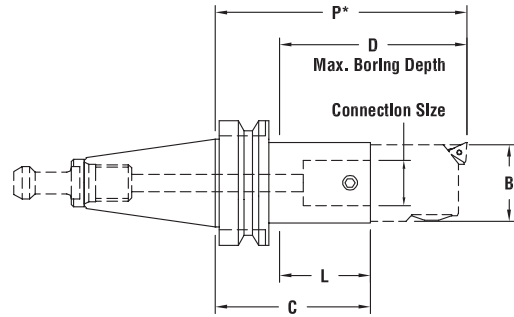

Order Retention Knob separately  
(see pages 98-101).

### 40 TAPER

Part Number	Connection Size	B	C	D	L	P*	Weight (lbs.)
<b>B40-PC2-4</b>	PC2	.94	3.80	4.12	2.64	5.28	2.5
<b>B40-PC3-4</b>	PC3	1.22	3.70	4.15	2.54	5.31	2.6
<b>B40-PC3-5</b>	PC3	1.22	4.80	5.25	3.64	6.41	3.2
<b>B40-PC4-3</b>	PC4	1.54	2.56	3.25	1.40	4.41	2.8
<b>B40-PC4-5</b>	PC4	1.54	4.53	5.21	3.36	6.38	3.6
<b>B40-PC5-3</b>	PC5	1.97	2.16	3.24	1.00	4.40	2.8
<b>B40-PC5-5</b>	PC5	1.97	4.13	5.21	2.97	6.37	4.2
<b>B40-PC6-4</b>	PC6	2.52	2.40	3.91	1.12	5.19	3.1

### 50 TAPER

Part Number	Connection Size	B	C	D	L	P*	Weight (lbs.)
<b>B50-PC2-4</b>	PC2	.94	4.15	4.03	2.54	5.63	7.7
<b>B50-PC3-4</b>	PC3	1.22	4.00	4.03	2.40	5.63	7.7
<b>B50-PC4-4</b>	PC4	1.54	3.78	4.03	2.18	5.63	8.1
<b>B50-PC5-4</b>	PC5	1.97	3.38	4.03	1.79	5.63	8.1
<b>B50-PC6-4</b>	PC6	2.52	2.84	4.03	1.24	5.63	8.8
B50-PC6-10	PC6	2.52	9.00	10.19	7.40	11.79	15.8

Part numbers in **bold face** are in-stock items.

\*Compute "P" dimensions by adding "C" dimensions of all components used.  
Maximum bore depth "D" may be increased by using extension adapters.

# Modular Shanks

## HSK Shanks

### BORING



H100A-PC6-4  
shown here.

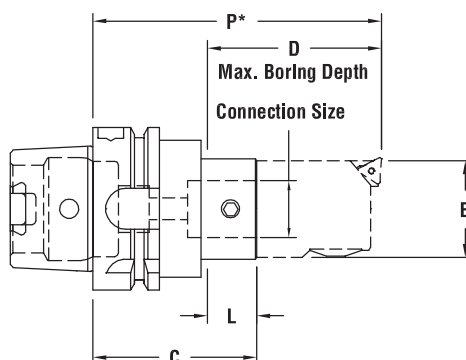

#### HSK 63A

Part Number	Connection Size	B	C	D	L	P*	Weight (lbs.)
H63A-PC2-73	PC2	.94	3.52	3.25	1.77	5.00	2.0
H63A-PC3-103	PC3	1.22	3.94	3.79	2.18	5.55	2.2
H63A-PC4-65	PC4	1.54	2.50	2.60	.75	4.35	2.3
H63A-PC4-178	PC4	1.54	6.00	6.10	4.25	7.85	4.0
H63A-PC5-105	PC5	1.97	3.26	3.74	1.50	5.50	3.1
H63A-PC6-100	PC6	2.52	3.25	4.29	1.50	6.04	3.4
H63A-PC6-147	PC6	2.52	5.13	6.16	3.37	7.92	6.0

#### HSK 100A

Part Number	Connection Size	B	C	D	L	P*	Weight (lbs.)
<b>H100A-PC2-107</b>	PC2	.94	3.52	3.25	1.77	5.00	2.0
<b>H100A-PC3-122</b>	PC3	1.22	4.92	4.66	3.05	6.53	6.4
<b>H100A-PC4-65</b>	PC4	1.54	2.50	2.48	.63	4.35	6.2
<b>H100A-PC4-182</b>	PC4	1.54	7.00	6.98	5.13	8.85	8.4
<b>H100A-PC5-122</b>	PC5	1.97	4.25	4.62	2.38	6.49	7.7
<b>H100A-PC6-100</b>	PC6	2.52	3.25	4.17	1.38	6.04	7.2
<b>H100A-PC6-190</b>	PC6	2.52	6.69	7.61	4.82	9.48	11.9

Part numbers in **bold face** are in-stock items. Other shank configurations available on request.

\*Compute "P" dimensions by adding "C" dimensions of all components used.  
Maximum bore depth "D" may be increased by using extension adapters.

BORING

# Modular Shanks

## NMTB Shanks & Straight Shanks



40 Taper  
N40-PC4-3  
shown here.

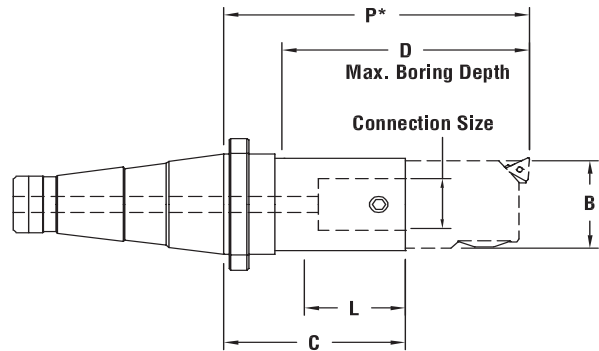

### 30 TAPER

Part Number	Connection Size	B	C	D	L	P*	Weight (lbs.)
N30-PC4-4	PC4	1.54	2.64	3.94	1.82	4.49	1.5

### 40 TAPER

Part Number	Connection Size	B	C	D	L	P*	Weight (lbs.)
N40-PC4-3	PC4	1.54	1.93	3.20	1.35	3.78	2.1
N40-PC6-4	PC6	2.52	2.17	4.14	1.34	4.97	6.4

### 50 TAPER

Part Number	Connection Size	B	C	D	L	P*	Weight (lbs.)
N50-PC4-4	PC4	1.54	2.87	3.94	2.09	4.72	6.4
N50-PC4-6	PC4	1.54	5.24	6.30	4.45	7.09	7.6
N50-PC5-4	PC5	1.97	2.48	3.94	1.70	4.72	6.6
N50-PC5-8	PC5	1.97	6.42	7.88	5.63	8.66	10.6
N50-PC6-4	PC6	2.52	1.93	3.94	1.15	4.72	6.4
N50-PC6-8	PC6	2.52	5.86	7.88	5.08	8.65	12.9
N50-PC6-12	PC6	2.52	10.59	12.60	9.81	13.38	17.8
N50-PC7-6	PC7	3.54	2.48	5.87	1.26	7.09	8.1



S20-PC6-4  
shown here.

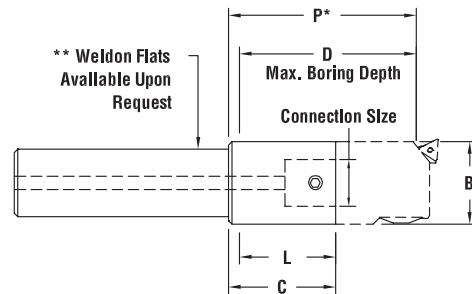

### STRAIGHT SHANKS

Part Number	Connection Size	B	C	D	G	L	P*	Weight (lbs.)
S12-PC4-3	PC4	1.54	2.00	3.75	1.25	1.90	3.85	2.0
S20-PC4-3	PC4	1.54	2.00	3.75	2.00	1.90	3.85	4.2
S12-PC6-4	PC6	2.52	2.00	4.70	1.25	1.90	4.80	3.1
S20-PC6-4	PC6	2.52	2.00	4.70	2.00	1.90	4.80	5.2

Part numbers in **bold face** are in-stock items.

\*Compute "P" dimensions by adding "C" dimensions of all components used.

Maximum bore depth "D" may be increased by using extension adapters.

\*\*For Weldon flats, add "W" after SXX, i.e., S12W-PC4-3.

Other shank configurations available on request.

# Modular Shanks

## Large Diameter Boring System—Ring Holders



### BORING

#### MODULAR BORING RING HOLDERS

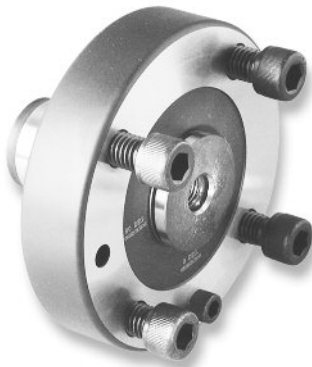

Boring Ring Holder PC7-17BR2 shown here.

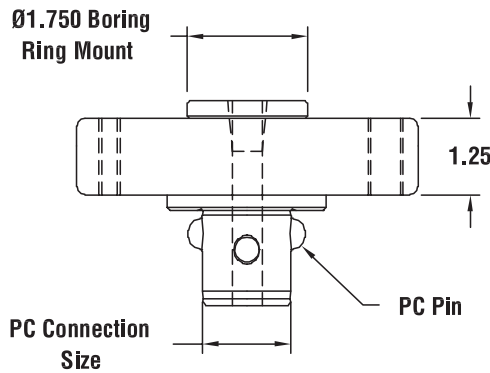

#### MODULAR BORING RING HOLDERS

Part Number	PC Connection	Weight (lbs.)
PC6-17BR2	PC6	6.5
PC7-17BR2	PC7	7.1

#### BORING RING ADAPTERS

- Integral shank for non-modular applications.



Boring Ring Holder PC7-17BR2 shown here.

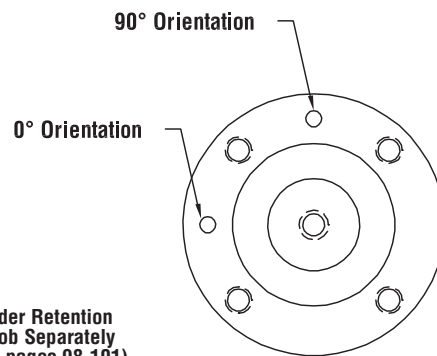

Order Retention Knob Separately (see pages 98-101)

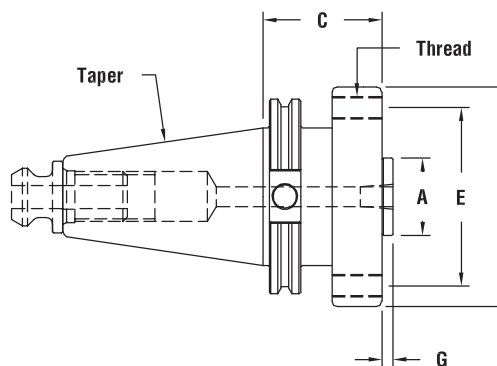

#### BORING RING ADAPTERS

Part Number	A (Dia.)	B (Dia.)	C	E	G	Thread	No. of Threads	Weight (lbs.)
<b>N50-17BR2</b>	1.750	4.94	2.00	4.00	.250	1/2-13	4	12.1
<b>C50-17BR2*</b>	1.750	4.94	2.50	4.00	.250	1/2-13	4	13.7
<b>C50-17BR5*</b>	1.750	4.94	5.00	4.00	.250	1/2-13	4	21.9

Part numbers in **bold face** are in-stock items.

\*Includes 90° tool tip orientation for clearance of oversize boring tools in carousels.

# Modular Components

## Extensions

### EXTENSIONS



Extension  
PC4-PC4E1  
shown here.

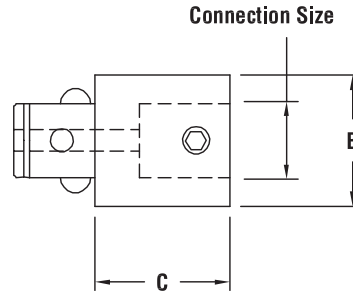

### EXTENSIONS

Part Number	Connection Size	B	C	Weight (lbs.)
PC2-PC2E1	PC2	.94	1.18	.3
PC2-PC2E2	PC2	.94	1.77	.4
PC3-PC3E1	PC3	1.22	1.18	.4
PC3-PC3E2	PC3	1.22	1.77	.5
PC4-PC4E1	PC4	1.54	1.57	.8
PC4-PC4E2	PC4	1.54	2.36	1.1
PC5-PC5E2	PC5	1.97	2.36	1.9
PC5-PC5E3	PC5	1.97	3.54	2.8
PC6-PC6E2	PC6	2.52	2.36	3.0
PC6-PC6E4	PC6	2.52	3.94	5.0
PC7-PC7E4	PC7	3.54	3.94	9.9
PC7-PC7E6	PC7	3.54	6.30	17.0

### HEAVY METAL EXTENSIONS\*



Heavy Metal  
Extension  
PC4-150HM15  
shown here.

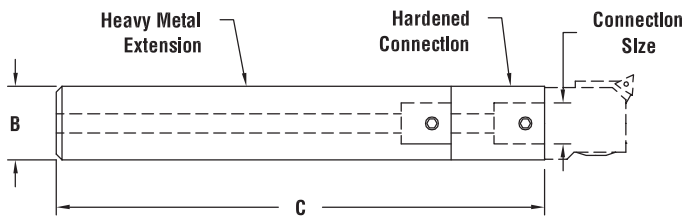

### HEAVY METAL EXTENSIONS

Part Number	Bore Dia. Min.	Bore Dia. Max.	Connection Size	B	C	Weight (lbs.)
<b>PC2-094HM11</b>	.98	1.30	PC2	.937	11.42	3.9
<b>PC3-125HM14</b>	1.26	1.65	PC3	1.250	13.78	9.0
<b>PC4-150HM15</b>	1.62	2.13	PC4	1.500	14.75	13.0

Part numbers in **bold face** are in-stock items.

\*Not recommended for use on lathes with twin bore units. Consult Parlec's Applications department.

# Modular Components

## Reductions & PC Screws



### BORING



Reduction  
PC6-PC4R3  
shown here.

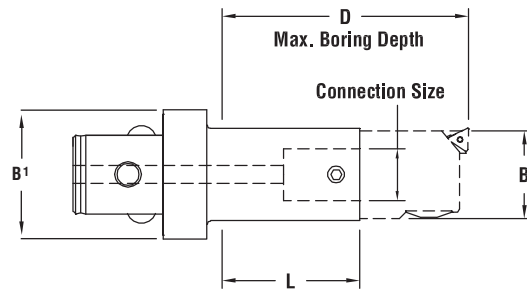

### REDUCTIONS

Part Number	A (Connection)	E (Connection)	B <sup>1</sup>	C	D	L (Max.)	M (Min.)	P*	Weight	B <sup>2</sup>
<b>PC3-PC2R1</b>	PC3	PC2	1.22	1.36	2.36	.965	.39	2.83	.4	.945
<b>PC4-PC2R2</b>	PC4	PC2	1.54	2.03	2.95	1.56	.47	3.50	.6	.945
<b>PC4-PC3R2</b>	PC4	PC3	1.54	1.85	2.95	1.38	.47	3.46	1.0	1.220
<b>PC5-PC2R2</b>	PC5	PC2	1.97	2.03	2.76	1.36	.67	3.50	.8	.945
<b>PC5-PC2R3</b>	PC5	PC2	1.97	3.21	3.94	2.54	.67	4.69	1.1	.945
<b>PC5-PC3R1</b>	PC5	PC3	1.97	1.85	2.76	1.18	.67	3.46	1.0	1.220
<b>PC5-PC3R3</b>	PC5	PC3	1.97	3.03	3.94	2.36	.67	4.65	1.3	.945
<b>PC5-PC4R1</b>	PC5	PC4	1.97	1.57	2.76	.91	.67	3.43	1.1	1.535
<b>PC5-PC4R2</b>	PC5	PC4	1.97	2.76	3.94	2.09	.67	3.61	1.6	.945
<b>PC6-PC2R2</b>	PC6	PC2	2.52	2.38	3.15	1.75	.63	3.85	1.5	.945
<b>PC6-PC2R3</b>	PC6	PC2	2.52	3.76	4.53	3.13	.63	5.24	1.8	.945
<b>PC6-PC3R2</b>	PC6	PC3	2.52	2.20	3.15	1.58	.63	3.82	1.7	1.220
<b>PC6-PC3R3</b>	PC6	PC3	2.52	3.58	4.53	2.95	.63	5.20	2.1	.945
<b>PC6-PC3R5</b>	PC6	PC3	2.52	5.35	6.30	4.72	.63	6.97	2.6	.945
<b>PC6-PC4R1</b>	PC6	PC4	2.52	1.93	3.15	1.30	.63	3.78	1.7	1.535
<b>PC6-PC4R3</b>	PC6	PC4	2.52	3.31	4.53	2.68	.63	5.16	1.3	.945
<b>PC6-PC4R5</b>	PC6	PC4	2.52	5.08	6.30	4.45	.63	6.93	3.0	.945
<b>PC6-PC5R1</b>	PC6	PC5	2.52	1.54	3.15	.91	.63	3.78	1.8	1.969
<b>PC6-PC5R3</b>	PC6	PC5	2.52	2.91	4.53	2.28	.63	5.16	2.8	.945
<b>PC6-PC5R4</b>	PC6	PC5	2.52	4.69	6.30	4.06	.63	6.93	4.1	.945
<b>PC7-PC6R4</b>	PC7	PC6	3.54	4.18	6.30	3.50	.70	6.97	7.0	2.52

Part numbers in **bold face** are in-stock items.

\*Compute "P" dimensions by adding "C" dimensions of all components used.  
Maximum bore depth "D" may be increased by using extension adapters.

### PC SCREWS

Part Number	Connection Size	Wrench	Tightening Torque
<b>880-002</b>	PC2	<b>018-102</b>	25 in. lbs.
<b>880-003</b>	PC3	<b>018-103</b>	42 in. lbs.
<b>880-004</b>	PC4	<b>018-104</b>	84 in. lbs.
<b>880-005</b>	PC5	<b>018-105</b>	168 in. lbs.
<b>880-006</b>	PC6	<b>018-106</b>	336 in. lbs.
<b>880-007</b>	PC7	<b>018-107</b>	840 in. lbs.

### PC SCREWS



PC Screw 880-006  
shown here.

