

Boring Head Holders

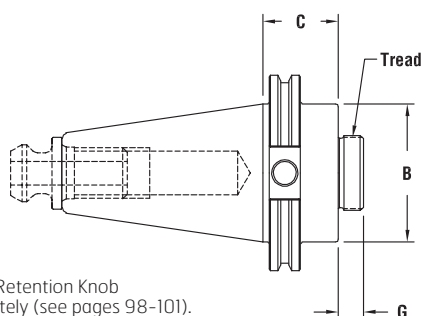

Boring Head Holder C40-62BH1 shown here.



Order Retention Knob separately (see pages 98-101).

- Constructed of alloy steel for long, durable service life.
- Hardened to RC 56-60 for long service life.
- Shiny taper with black oxide finish for the best combination of accuracy and durability.
- Parsymmetry™ design for high-speed operation.
- Plastic bumper protects spindle and holder during tool changes. Available on NMTB 40 and 50 arbors only.

All boring head holders meet or exceed appropriate standards. See Technical Section in front of catalog for specifications.

TOOLHOLDING

1/2 - 20" BORING HEAD HOLDERS

Part Number	Taper Type	B	C	G	Thread	Fit
C40-50BH1	CAT 40	1.75	.87	.57	1/2 - 20	Tapmatic

5/8 - 18" BORING HEAD HOLDERS

Part Number	Taper Type	B	C	G	Thread	Fit
C40-62BH1	CAT 40	1.25	1.50	.45	5/8 - 18	Bridgeport #1 Boring Head, Erickson #37 or #50

7/8 - 20" BORING HEAD HOLDERS

Part Number	Taper Type	B	C	G	Thread	Fit
C40-87BH1	CAT 40	1.75	1.50	.44	7/8 - 20	Criterion Boring Head
C40-87BH188	CAT 40	1.75	1.88	.50	7/8 - 20	Criterion Boring Head
C50-87BH1	CAT 50	1.75	1.50	.44	7/8 - 20	Criterion Boring Head
N30-87BH1	NMTB 30	1.75	1.50	.44	7/8 - 20	Criterion Boring Head
N40-87BH1	NMTB 40	1.75	1.00	.44	7/8 - 20	Criterion Boring Head

1 1/2 - 18" BORING HEAD HOLDERS

Part Number	Taper Type	B	C	G	Thread	Fit
C40-15BH188	CAT 40	2.73	1.88	.56	1 1/2 - 18	Criterion Boring Head
C40-15BH2	CAT 40	2.75	2.00	.56	1 1/2 - 18	Criterion Boring Head
C50-15BH1	CAT 50	2.75	1.50	.50	1 1/2 - 18	Criterion Boring Head
N40-15BH1	NMTB 40	2.75	1.50	.50	1 1/2 - 18	Criterion Boring Head
N50-15BH1	NMTB 50	2.75	2.00	.50	1 1/2 - 18	Criterion Boring Head

Part numbers in **bold face** are in-stock items. Other projection and taper sizes available on request. Please call Parlec for more information.

Blank Bars



Blank Bar
C50-40BB7
shown here.

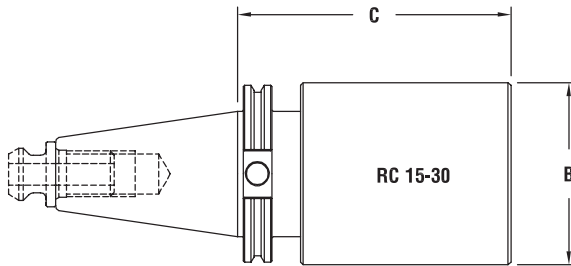

Order Retention Knob separately (see pages 98-101).

- Constructed of ANSI 8620 steel for long, durable service life.
- Taper hardened to RC 56-60 for long service life.
- Body hardened to RC 15-30 to allow for machinability.
- Shiny taper with black oxide finish for the best combination of accuracy and durability.
- Parsymmetry™ design for high-speed operation.
- Plastic bumper protects spindle and holder during tool changes. Available on NMTB 40 and 50 blank bars only.

BLANK BARS

Part Number	Taper Type	B	C
B30-23BB500	BT 30	2.38	5.00
B40-30BB700	BT 40	3.00	7.00
C40-25BB8	CAT 40	2.50	8.00
C50-27BB8	CAT 50	2.75	8.00
C50-40BB1	CAT 50	4.00	11.00
C50-40BB7	CAT 50	4.00	7.00
C50-61BB7	CAT 50	6.12	7.00
N30-20BB3	NMTB 30	2.00	3.75
N40-25BB512	NMTB 40	2.50	5.12
N50-39BB912	NMTB 50	3.90	9.12
N50-50BB912	NMTB 50	5.00	9.12
PC4-20BB6	PC4	2.00	6.00
PC5-30BB4	PC5	3.00	4.00
PC6-25BB9	PC6	2.50	9.00

Part numbers in **bold face** are in-stock items. Other projection and taper sizes available on request. Please call Parlec for more information.

*For information on Modular Shanks, Extensions and Reductions, refer to Boring Section (page 103).